

VIEW A-A

Valve control: 19mm hex socket.
A dry stem sealed directly at the valve body ensures greater operational safety and compensates for possible pre-insulation errors.
The stem consists of tubes 38x3 and 21x3.
*A different valve height is available upon request.

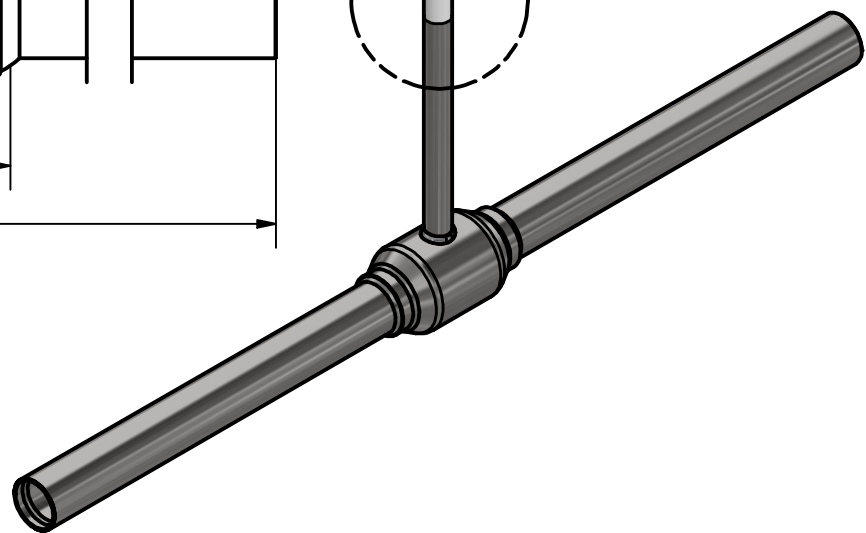

product code: <b>GLOBTOS P65-25 F 515 1,5</b>		manufacturer: <b>FWBV.com</b> Fully Welded Ball Valves	
product name: <b>GLOBTOS preinsulation dn65 pn25 full bore hex19 H=515 L=1510</b>		prepared for: <b>GLOBTOS</b> valve technology	
www.GLOBTOS.com pl@globtos.com +48726500100			
drawn by: Janusz Ośmiałowski	date: 01.02.2024	scale: 1 / 3	notes:
checked by: Tomasz Ośmiałowski	version:	sheet size: A4	
approved by: Jacek Pawlikowski	weight: 20,1kg	unit: mm	