

Valve control: 19mm hex socket.
A dry stem sealed directly at the valve body ensures greater operational safety and compensates for possible pre-insulation errors.
The stem consists of tubes 34×3.5 and 60×4.
*A different valve height is available upon request.

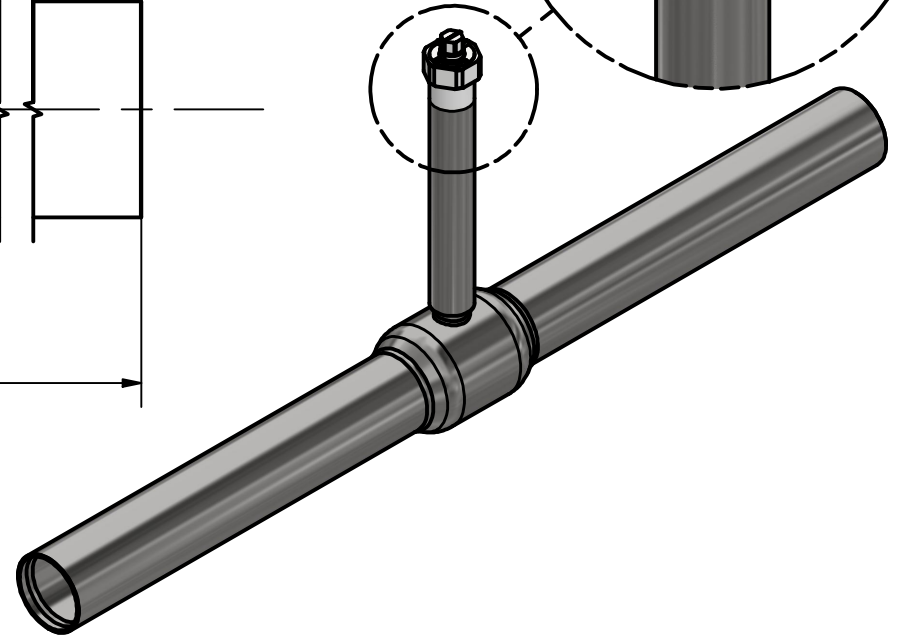

product code: GLOBTOS P100-25 525 1,5		manufacturer: FWBV.com Fully Welded Ball Valves	
product name: GLOBTOS preinsulation dn100 pn25 hex 27/70 H=525 L=1510		prepared for: GLOBTOS valve technology	
www.GLOBTOS.com pl@globtos.com +48726500100			
drawn by: Janusz Ośmiałowski	date: 01.02.2024	scale: 1 / 4	notes:
checked by: Tomasz Ośmiałowski	version: 1.0	sheet size: A4	
approved by: Jacek Pawlikowski	weight: 32,5kg	unit: mm	